

Trawl - Protected Species Risk Management Plan

FV	Vessel ID	Home Port
Owner	Skipper/s	Date
Vessel photo	Mitigation photo- offal control equipment	Mitigation photo- warp device

Purpose of this PSRMP

This PSRMP documents agreed procedures and actions that skippers of this vessel will follow to reduce risk of protected species captures and includes implementation of best practice as outlined by the Mitigation Standards. **This document is to be prominently displayed onboard.** Skipper(s) and crew must also read and understand the supporting 10 Golden Rules & Operational Procedures.

Regulated measures for protected species reporting

All protected species captures should be reported using the electronic NFPS Catch Report.

Remember it is not illegal to catch a protected species however it is illegal not to report it!

Vessel's Practices	
1. Fish waste management <i>Describe equipment and procedures to hold or batch fish waste; contingency plan where required</i>	- <u>No continuous discharge when towing</u> ; no discharge immediately before/during setting or hauling. While towing, fish waste is held or batched. <u>Cut & offal discards:</u> <u>Whole and fish waste discards:</u> <u>List discharge storage & batching procedures & discharge point, (for the above, etc)</u>
2. Warp <i>Describe equipment and procedures, type of device. When is deployment required?</i>	-Warp (located closest to side where fish waste is discharged) protected by seabird scaring device <u>List Seabird device type- carried onboard (Baffler, warp-deflector, tori, other etc)</u> -Seabird scaring device deployed <u>(choose: at all times or when there is any potential risk to seabirds)</u> and in a way to not increase the risk to seabirds (ie. excessive trailing streamers) -Carry sufficient spares to effect repairs
Warp splice control	Warps are not overly greased; warp splices are wrapped; sprags are removed; warp splices are not near water's surface when towing
3. Net interaction	Haul as quickly as practicable to minimise time net is at/near surface
Stickers	All practicable stickers are removed from the net before each shot.
Gear maintenance/repair	Is conducted while net is onboard or during low risk periods (ie. night or low seabird abundance) Regularly inspect and maintain all fishing gear/equipment (eg. winches)
4. Deck landing/impact	Reduce unnecessary deck lighting, while maintaining safe lighting practises
Training	Crew know and follow safe marine mammal & seabird-handling procedures and protocols Return live fish to the sea as soon as practicable after they were landed
Other- gear/mitigation	

Contact your Liaison Officer when a TRIGGER POINT is reached.

Any 24 hr period

(Alive or Dead) Any great albatross, penguin, dolphin, sea lion or basking shark

(Alive or Dead) First turtle of the fishing year (Oct- Sept)

(Alive or Dead) 3 large (e.g. albatross/mollymawk, giant petrel, gannet), or 5 small (e.g. petrel/shearwater) seabirds, or 2 fur seals

(Dead) Any black petrel or flesh-footed shearwater

Any 7-day period

(Alive or Dead) 10 protected seabirds of any type, or 3 turtles, or 5 fur seals

Contact:	Ph:	Email:
----------	-----	--------

Information in this plan will be provided to MPI and FINZ for reporting and management purposes

Information in this plan will be provided to MPI and FINZ for reporting and management purposes

DOC CSP Liaison Programme Risk Mitigation: Trawl (2020.21)

TEN GOLDEN RULES FOR COASTAL TRAWLING TO SAVE PROTECTED SPECIES

1. Ensure your vessel has onboard:
 - a. The vessel's Protected Species Risk Management Plan (PSRMP),
 - b. The Coastal Trawling Operational Procedures, and
 - c. A map of areas where trawling is prohibited.
2. Hold all fish waste immediately before or during shooting/hauling and batch discharge away from the path of warps if/when towing.
3. Always have fit & proper bird scaring device/s onboard.
4. Always deploy mitigation devices if there is any risk to seabirds (when birds are present or when discharging fish waste near warps).
5. Ensure the warps are not overly greased; all warp splices are 'wrapped'; any sprags are removed or 'whipped'; and warp splices are not near the water's surface.
6. Minimise time trawl gear is at/near the surface. Where possible, conduct gear maintenance/repairs while net is on board.
7. Remove stickers from net before shooting especially small fish and squid.
8. Reduce unnecessary deck lighting
9. Crew know and follow safe handling procedures for captured animals (dead or alive)– return protected species to sea quickly and treat with care.
10. Report all protected species captures by ERS or in the Nonfish Protected Species Catch Return (NFPSCR) logbook and send to FishServe. **It is illegal not to report.** Report protected species trigger level captures to Liaison Officer.

For support phone your local Liaison Officer.

TEN GOLDEN RULES

NON-FISH OR PROTECTED FISH SPECIES (NFPS) CATCH REPORTS

- 1.** The Fisheries (Reporting) Regulations 2017 require reporting of **all** NFPS captures (dead or alive). It is an offence to fail to report.
- 2.** All permit holders and skippers must know the law and be able to file an NFPS catch report using their vessel's Electronic Reporting system.
- 3.** Fisheries New Zealand observers file their own NFPS catch reports, but this does NOT mean the vessel's obligation to report has been removed.
- 4.** *Captures* means that the NFPS has become fixed, entangled, or trapped in such a way that it cannot move freely or free itself from any part of the fishing gear. (includes for example tori lines and paravanes)
- 5.** *Deck strikes* means seabirds injured or dead from colliding with the vessel, or any that need crew assistance to leave the vessel because they are disoriented.
- 6.** Treat all animals with respect and care (dead or alive).
- 7.** Return all NFPS to the sea promptly and carefully unless required to be kept on board by a Fisheries New Zealand observer.
- 8.** Unauthorised retention or any further interference with protected species is an offence under the Wildlife Act 1953.
- 9.** If unsure of the species name (NFPS code) use the generic codes provided.
- 10.** E-logbook Users Instructions and Codes can be found here:
<https://www.fisheries.govt.nz/dmsdocument/37982-Fisheries-E-logbook-Users-Instructions-and-Codes-Circular-2019>

Non-Fish or Protected Fish Species Catch Report - Summary Information

(from Fisheries New Zealand Electronic Catch and Position Reporting Guide July 2019)

You must complete an NFPS Catch Report if there is an interaction with the following by the vessel or gear during a trip:

- Birds;
- Marine mammals (e.g. New Zealand fur seal);
- Marine reptiles (e.g. turtles);
- Protect fish species (e.g. basking shark, great white shark, manta ray, black spotted grouper);
- Selected benthic organisms (corals, sponges, and bryozoans).

You will be prompted for more information about how the capture happened if a seabird is taken during trawling or surface or bottom longlining.

You must take care when choosing codes where there is a group option and a specific option so that you do not accidentally report an organism twice.

If there is more than one NFPS capture during an event, they will all be recorded on the same NFPS Catch Report.

The NFPS Report must be completed and provided at the same time as the Fish Catch Report, if it occurs as part of a fish catch event.

If the capture happens while you were not actually fishing (e.g. while steaming), the NFPS Catch Report will be a standalone report, i.e. it will not be linked to a Fish Catch Report and must be completed and provided to FishServe before the end of the day on which you became aware of the capture.

Online resources to assist you with NFPS identification

- The DOC website has material on coastal and deep water seabird species. Guides include MPI reporting codes and are available in multiple languages: doc.govt.nz/our-work/conservation-services-programme/csp-resources-for-fishers/a-fishers-guide-to-new-zealand-seabirds/
- A fuller set of invertebrate NFPS material is available at: fs.fish.govt.nz/Doc/23020/AEBR_86.pdf.ashx
- A coral guide is available at doc.govt.nz/Documents/conservation/marine-and-coastal/fishing/coral-id-guide-updated.pdf

North Island Coastal Trawler

Operational Procedures for Protected Species Risk Management

Version 2.1 August 2021

FISHERIES
INSHORE NEW ZEALAND

Contents

Background, Rationale and Purpose	3
Managing Risk Associated with the Coastal Trawl Fishery	5
Risk Management Plan Responsibilities	6
Reporting Protected Species Captures	7
Trigger Limits & Vessel Action.....	7
Real Time Reporting Triggers	7
Trigger breach Reporting Contact - 24/7	7
Fisheries NZ Reporting Requirements	7
Animal Handling/Release and Crew Safety	8
Audit & Review	9

Disclaimer: This document has been produced to serve as a guide to the fisheries regulations relevant to commercial inshore trawl fishing operations for use by the industry. This is not intended to be used as a substitute to any statutory, regulatory and/or non-regulatory requirements for inshore trawl fishing. Before acting in reliance, either wholly or partially, on any information contained in this document, readers should seek advice as to how current legislation, rules and regulations may affect their interests. It is the duty of the operator to know and understand the current regulations that apply.

MPI has stated that at-sea inspections will become more directed as a result of the availability of GPR data. Make sure you know what you need to meet legal requirements on protected species mitigation measures and reporting. Please contact your Liaison Officer for support if you need assistance.

Background, Rationale and Purpose

Background and Rationale

The North Island coastal vessels (under 28 m LOA targeting inshore stocks) trawl fishery has had observed captures and risk assessments of seabirds that require a structured approach to mitigation of that risk.

The characteristics of coastal trawl fishing which increase the risk of incidental captures of seabirds are:

- warps towing from blocks outboard of the vessel hull
- extended periods during which the gear is on or near the surface
- feed attraction from high levels of fish waste - offal and discards
- fishing grounds and seasons in some areas with high seabird numbers.

All protected species with observed captures in this fishery are of significant importance to the community and some are rare (i.e. have very small and/or threatened populations). The Government will be responsive in ensuring that undue impacts are not occurring on these species. It is in the best interests of this fleet to take all reasonable steps to acknowledge, understand and mitigate impacts on protected wildlife encountered.

Purpose

The purpose of these North Island Coastal Trawl OPs is to ensure:

- risks of protected species mortalities are mitigated by reducing the risk of capture
- that by implementing this OP and associated vessel PSRMP the vessel crew is actively involved in protected species mitigation measures and undertakes improvements through ongoing on board observation, review and improvement processes, i.e. **Look – Think – Act**
- that all vessels in the fleet have the same information as well as robust and documented systems to manage protected species risk and therefore are working together as a fleet to manage the risks
- vessels report as required and as accurately as possible all capture events (MPI reporting) as well as any event triggers required by the OP systems are able to stand up to audit or review by vessel owners, skippers, or Government.

Seabirds

National Plan
of Action
(NPOA) and Risk
Assessment

The National Plan of Action (NPOA) for Seabirds is part of an internationally visible management framework for seabirds. The NPOA sets out objectives for the next five years to guide management of risk to seabirds in New Zealand fisheries, led by Fisheries New Zealand (FNZ) with support from Department of Conservation (DOC) and industry bodies such as Fisheries Inshore NZ (FINZ) and Southern Inshore Fisheries Management Co.

The Risk Assessment referred to in the NPOA is a useful guide to assess the impact of potential fisheries mortalities on 93 of the seabird species that breed in the New Zealand region. A risk 'factor' for each seabird species is estimated as the ratio between the estimated annual potential fatalities due to fisheries and the number that the population can withstand and stay healthy or grow. The risk ratios are assessed on a fishery-by-fishery basis where data is sufficient to allow this. A key part of the NPOA is the objective to move seabird species to a lower risk category within the five-year period.

The NPOA process also developed the **Mitigation Standards to Reduce the Incidental Captures of Seabirds in New Zealand Commercial Fisheries (Toolbox of Measures)**. This document outlines statutory requirements for bycatch mitigation, and some that are above and beyond statutory requirements. The fishing industry focuses on ensuring our fleets are at a minimum, meeting statutory requirements but encourages all vessels to meet the mitigation standards as appropriate to their vessel operations.

Marine Mammals

The Government evaluates the risk that commercial fishing presents to marine mammals and has implemented national management regimes for Hector's and Maui dolphins through area-specific setnet and trawl controls. Maui and Hector's dolphins are also the focus of a DOC Threat Management Plan (TMP). Like seabirds, these mitigation measures will continue to be reviewed accordingly.

Marine Reptiles

Occasional interactions with marine turtles in trawl nets do occur. Turtle capture rates are increasing across other fleets, so could be expected to occur more.

Managing Risk Associated with the Coastal Trawl Fishery

Seabirds and marine mammals are attracted to offal and discards (fish waste) from the vessel or whole fish in the trawl net or fish disturbed by the passing of the net. Once attracted, they are at risk of injury from the gear or drowning in it.

Risk to seabirds and marine mammals in your region is driven by two main factors and how they interact:

Risk Item	Risk For	Ways to manage risk
Net captures	Seabirds (mostly petrels, shearwaters, shags and penguins), marine mammals and turtles	<ul style="list-style-type: none"> Net captures occur during both shooting and hauling of the net. Therefore, it is important that the vessel prevents offal discharges both before and during hauling and shooting. Minimising the amount of time the net is on the surface will also reduce this risk. So, getting the gear to fishing depth and later aboard quickly is important. Avoid trailing the gear in the water while mending. Avoiding setting the net when large numbers of birds or mammals are present <p>Ensuring that the net is clean of stickers and other food attractants when being set</p>
Warp capture	Seabirds (mostly albatross)	<ul style="list-style-type: none"> Stopping or controlling (batching) offal/waste discharge while warps are in the water will greatly reduce or even eliminate interactions - this is the PRIMARY risk reducing measure Fit and proper mitigation devices (tori lines, bafflers, deflectors or scarers), well designed, and implemented will serve to keep seabirds away from the warp danger area (see recommended devices at the back of this OP) <p>Ensuring warp splices are 'wrapped', and any sprags removed and 'whipped'</p>

Regions and Periods of Risk for Seabird & Marine Mammal Species

Currently four seabird species that have been observed captured by the coastal trawl fleet are known to be high or very high-risk category and warrant immediate and ongoing reduction in captures or risk of capture. Captures occur in all areas frequently fished by the fleet.

Species at Risk	Species Code	Main Risk Area	Place, Time, Risk Profile
Black petrel	XBP	East Coast North Island and Kermadec	<ul style="list-style-type: none"> Nests on Great and Little Barrier, active in BOP, HG, Northland in autumn, summer, spring. Highest risk seabird in FNZ Risk Assessment Nationally Critical Aggressive feeders
Flesh-footed shearwater	XFS	East Coast North Island (particularly FMA1) and Kermadec	<ul style="list-style-type: none"> Nests on many off lying islands around upper North Island, most common autumn, summer, spring. Third highest risk species in Fisheries NZ Risk Assessment Aggressive feeders
Salvin's and White capped albatross	XPB	East and West coasts North Island	<ul style="list-style-type: none"> Occasionally visitors to upper North Island coasts year-round but especially spring/summer Aggressive feeders
Penguins and Shags	XPG (penguin) XHG (shag)	All coastal areas	<ul style="list-style-type: none"> Can forage well out to sea but usually coastal near breeding colonies or roosts onshore Birds that form rafts i.e. large flocks, on sea can pose a risk
Common Dolphins	CDD	All coastal areas	<ul style="list-style-type: none"> Most common marine mammal caught in inshore trawl fishery Around all of North Island though more prevalent in the northern regions
Maui & Hector's dolphins	MDO (Maui) HDO (Hector's)	West Coast NI	<ul style="list-style-type: none"> West Coast, often shallow, dirty water off river mouths and harbours, infrequently seen on East Coast Maui – nationally critical and Hector's – Nationally vulnerable
NZ Fur Seal	FUR	All coastal areas	<ul style="list-style-type: none"> Can forage well out to sea but usually in coastal waters Year round and increasing in northern regions

Risk Management Plan Responsibilities

Responsibilities of Operator and Skipper

- Ensure all crew are briefed on these OPs, the vessel's PS-RMP and fully understand all the actions required
- Be aware of seabird/mammal activity around the vessel, assess risks and take those actions needed to minimise risk
- Ensure shooting and hauling carried out as quickly as possible and with regard to protected species activity in immediate area
- Batch discharge equipment is available and fish waste is not discharged when shooting and hauling
- Monitor crew removal of stickers from net prior to shooting
- Deploy mitigation measures (fish waste management and warp device) whenever seabirds are at risk from warps
- Deploy and/or adjust mitigation measures to best suit weather, fishing and processing conditions to minimise risk of seabird interactions
- Regularly inspect warps and ensure they are spliced using methods that do not leave sprags (i.e. splices should be wrapped and sprags whipped)
- Display a copy of "The 10 Golden Rules for NI Coastal Trawl Vessels" on the bridge
- Ensure correct reporting (MPI) and that trigger reports are sent promptly to the Liaison Officer identified on your PS-RMP.
- Ensure crew are meeting their responsibilities listed below.
- Address any deficiencies in implementation of the PSRMP as noted by any observer, and address the effectiveness and content of the PSRMP if any triggers are exceeded.

Responsibilities of Crew

- Do not discharge offal and fish waste prior to or during hauling and shooting periods to reduce bird numbers in the net danger zone
- Shoot and haul the net as quickly as practicable and always minimise the time the net remains on or near the surface
- Remove stickers and food attractant from net before shooting
- Maintain a watch of seabird and mammal activity around the vessel and advise the skipper as appropriate when it is clear there is risk that requires action including:
 - Not shooting in presence of significant feeding activity
 - Altering hauling speed and operation to reduce risk
 - Advising if any animal seen caught and ensuring its immediate release if alive
 - Carry and deploy a fit and proper bird scaring device as described in the vessel's PS-RMP and spare parts to rebuild/replace if damaged or lost

Reporting Protected Species Captures

Trigger Limits & Vessel Action

Trigger Limits are the FINZ real time reporting 'threshold' system. Once a 'trigger' is reached, the Liaison Officer, FINZ, and the operator/owner and skipper (noting these might be the same person at times) will review the situation. Whenever appropriate, the vessel crew may need to take additional steps to mitigate risk of further capture events.

Real Time Reporting Triggers

Triggers include:

Any 24 hr period

- (Alive or Dead) Any great albatross, penguin, dolphin, sea lion or basking shark
- (Alive or Dead) First turtle capture of fishing year (Oct-Sep)
- (Alive or Dead) 3 large (e.g. albatross/mollymawk, giant petrel, gannet), or 5 small (e.g. petrel/shearwater) seabirds, or 2 fur seals
- (Dead) Any black petrel or flesh-footed shearwater

Any 7-day period

- (Alive or Dead) 10 protected seabirds of any type, or 3 turtles, or 5 fur seals

Trigger breach Reporting Contact - 24/7

The vessel (directly) or the onshore Vessel Manager must notify the Liaison Officer **within 24 hours** of any trigger breach so that any follow-up deemed necessary can be discussed and carried out.

Emails from Sat-C or texts are OK.

Your Liaison Officer's contact details are shown on your Protected Species Risk Management Plan.

Fisheries NZ Reporting Requirements

Fisheries NZ Reporting Requirements – All protected species captures

It is not illegal to accidentally capture protected species while commercial fishing, but it is illegal to fail to report the capture.

- It is important that all captures and mortalities are reported accurately. All protected species landed dead or alive (then returned to the sea) must be recorded in the **Non-Fish Protected Species Catch Return form** (NFPSCR) or the Electronic reporting system equivalent.
- Fisheries NZ observers may decide to keep some protected species caught for formal identification autopsy. They are permitted to do so. The vessel may only do so if it holds a current DOC permit.

Always meet your legal requirements.

Definitions

Capture: *An animal (dead or alive) which is brought onboard on/by the fishing gear and requires assistance/help off the vessel.*

Deck-Strikes: *Birds that 'collide' with the vessel/deck/superstructure and are dead or injured, unable to leave vessel of its own accord; report as 'deck-strikes' (not reported if alive and leaves the vessel unassisted, i.e. landed on vessel)*

Seabirds

Use the XAL (unidentified Albatross/mollymawk) and XXP (unidentified Petrels & Shearwaters) species codes if you are not 100% sure of the species identification. If you are 100% sure, use the species individual codes supplied by MPI

Marine Mammals

If possible, report captures at species level. If unsure, use generic codes. You may take photos of the head, whole body and any distinguishing marks on a marine mammal to share with your Liaison Officer who may identify the marine mammal for you. Do this without any crew or vessel features in the picture

Leg bands

Record any leg band numbers on the form, these are really important and FINZ urges skippers to record any leg bands. Take a photo if possible and send to your Liaison Officer

Animal Handling/Release and Crew Safety

Release Alive	<p>Every care should be taken to release animals alive, reduce stress and handle with care to minimise any further harm or injury to the animal, and to increase survivability when it is being returned to the sea alive.</p> <p>Deliberately harassing or harming these animals after an incidental capture is an offence.</p>
Birds	<ul style="list-style-type: none"> • Keep the bird calm by covering the head with a cloth. Use two crew; one to support the bird, while the other frees the gear from the bird. Use gloves and eye protection (beware large birds can inflict a nasty bite). • Carefully isolate the tangled meshes. Peel the netting back over the tail, feet, and then the wings, while holding the bird firmly. Remove the head from meshes last. • When freed, place the bird gently back into the water. If the bird is waterlogged keep it in a safe place, such as an empty fish case, until it has recovered.
Marine Mammals	<ul style="list-style-type: none"> • If possible, give animals time and space to leave the vessel. Do not take actions that will antagonise the animal. Watch carefully for signs of aggression in the animal. • Do not allow crew to be in its path or escape route, use netting as a moving barrier or a deck hose to persuade/guide the animal back to the sea.
Turtles	<ul style="list-style-type: none"> • Release the turtle in the water
Returning Dead Seabirds and Marine Mammals to the Sea	<p>The entire body of any dead protected species must be returned to the sea, unless a FNZ observer onboard the vessel directs the skipper to, or they themselves keep it or the skipper has been advised otherwise by DOC or Fisheries NZ. Usually they only keep seabirds and Maui dolphins.</p> <p>Taking any part and keeping it or cutting or mutilating the body of a protected species is an offence.</p>
Seal Handling and Crew Safety Issues	<p>Seals can carry a number of infectious diseases which can infect humans. Live marine mammals can also be potentially dangerous to humans particularly when they are in stressful situations. Handling marine mammals should always be kept to a minimum and should only occur if and when needed.</p> <p>When attending to animals landed on deck the following steps should be followed to ensure crew safety:</p> <ul style="list-style-type: none"> • Whenever handling bodies of drowned fur seals, or any other marine mammals, wear waterproof gloves and waterproof protective clothing • Where possible, avoid direct contact with blood, urine, faeces and other body fluids. It is also important to avoid the mouth of the marine mammal as this is a major source of disease. • If bitten or grazed by a marine mammal, as a first measure wash and disinfect the wound immediately, apply betadine/antiseptic ointment and cover the wound. This minimises the risk of 'seal finger', a chronic and very painful infection caused by bacteria carried by some marine mammals. Visit a doctor once ashore as infection is very common with seal and sea lion bites. • After handling any marine mammal, crew should wash their hands and forearms with antibacterial soap and their protective clothing by hose down.

Audit & Review

Audit & Review

Government fisheries observers on your vessel will audit the implementation of your PSRMP. Information they collect will be provided to DOC, Fisheries NZ and the Liaison Officer.

If your PSRMP is not being implemented effectively, it means that either the Plan needs updating or practices onboard need to be improved. Your Liaison Officer can work this through with you and update your Plan if necessary.

Your PSRMP may also need updating at other times. For example, if you change gear or target species, or there are changes in any element of your fishing operations that relate to the risk of protected species captures. At these times, please contact your Liaison Officer.

Hector's and Māui dolphins Threat Management Plan

North Island fisheries measures



Below is a summary of the new fisheries measures to support the Threat Management Plan for Hector's and Māui dolphins, which come into effect on **1 October 2020**.

Hector's and Māui dolphins are only found in New Zealand waters and together are one of the world's rarest dolphin species.

Extensive measures are already in place to reduce fishing-related threats to Hector's and Māui dolphins and more is needed to be done to protect them.

The Government is extending and creating new areas that will prohibit the use of commercial and recreational set-nets in both the North Island and South Island.

While trawl fishing poses a lower risk of fishing-related mortality, given the critically endangered status of the Māui dolphin, the Government is also extending the trawl prohibition within the central Māui dolphin habitat zone.

What does this mean for the North Island?

The west coast North Island, from Cape Reinga down to Wellington, will see new measures introduced.

- New commercial and recreational set-net closures out to 4 nautical miles offshore will be created between Cape Reinga and Maunganui Bluff, and between Hawera and Wellington.
- Set-net closures will be extended between Maunganui Bluff and the Waiwhakaiho River (New Plymouth) from 7 nautical miles to 12 nautical miles offshore, as well as between the Waiwhakaiho River and Hawera from 2 nautical miles to 7 nautical miles offshore.
- Set-net closures within the Manukau Harbour will be extended to Taumatarea Point in the north and Matakawau Point in the south within the harbour.
- An extension to commercial trawl closures between Maunganui Bluff and Pariokariwa Point will be put in place, extending south to the Waiwhakaiho River (New Plymouth) and to 4 nautical miles offshore. This falls within the central Māui dolphin habitat zone.
- Commercial and recreational drift netting will be banned in its entirety in all New Zealand waters.
- A change to the regulations allows the Minister to act immediately to impose further restrictions if a single dolphin is caught in the Māui dolphin habitat within the west coast of the North Island.

How do the measures affect commercial fishers?

The measures will prevent commercial set-net fishing in the areas outlined above, extend closures to trawl fishing in the central Māui dolphin habitat zone, and prohibit drift netting in all New Zealand waters. These changes are significant to fishers who operate between Maunganui Bluff and Hawera, given the scale of the offshore extensions. However, the measures will also be notable in the Northland, Manawatu-Whanganui, and Wellington (Kapiti) regions where there are currently few or no commercial restrictions on the use of set-net.

An additional new measure will enable the use of commercial ring nets in set-net prohibition areas within west coast North Island harbours; this fishing method poses a low risk to Māui dolphins.

Other commercial fishing methods including drag netting and beach seining may continue to be used unless otherwise prohibited.



Fisheries New Zealand

Tini a Tangaroa

Will the new measures impact customary fishing?

Tangata whenua may still authorise customary fishing to be carried out by non-commercial or commercial fishers, with or without a fishing vessel, using any type of gear or method.

What do the measures mean for recreational fishers?

Recreational fishers will no longer be able to fish using set-nets in the areas outlined above, or drift net in any New Zealand waters. The set-net changes will be notable in the Northland, Manawatu-Whanganui, and Wellington (Kapiti) regions where there are currently few or no restrictions on the use of set-net.

Other recreational fishing methods including drag netting and beach seining may continue to be used unless otherwise prohibited.

What does this look like in your area?



For more information, please visit www.fisheries.govt.nz/dolphintmp or contact dolphintmp@mpi.govt.nz



Seabird Bycatch Mitigation Standards Guide

Under 28m Trawl

What Are Seabird Bycatch Mitigation Standards?

August 2021

The seabird bycatch Mitigation Standards were developed alongside the NPOA Seabirds 2020. They document the 'best practice' mitigation methods for reducing the risk of seabird captures in New Zealand commercial fisheries. It is expected that by 2025 each vessel will have a Protected Species Risk Management Plan (PSRMP) that is tailored to their operational needs and works towards achieving the best bycatch mitigation options available.

These Mitigation Standards do not replace or override any fisheries regulations, or legislation on workplace health and safety, maritime safety, or other relevant subject.



'Best Practice' Mitigation Methods

1. Control the discharge of fish waste

- No discharging of fish waste immediately before or during shooting or hauling.
- During the tow, only discharge fish waste if it is batch discharged.
- Document a plan for fish waste discharge should there be any equipment failures. Keep a copy on board.
- Whilst still allowing the free movement and egress of water, maintain a secondary system that prevents uncontrolled fish waste discharge (*i.e.* equipment to minimise fish waste lost to factory floor or deck, grating and/or trap systems in fish sorting and gutting areas that lead overboard).

2. Protecting seabirds from trawl warps

- While discharging fish waste, have a seabird scaring device on/near the warp nearest to the side discharging.
- Ensure the seabird scaring device is well maintained, with spare parts onboard.
- Ensure warps are well maintained (*i.e.* not overly greased, splices 'wrapped', sprags removed or 'whipped', and splices are not near the water's surface).
- Seabird scaring devices do not need to be deployed if the vessel is operating at a time and place that the operator and Liaison Officer agree poses no risk to seabirds.

3. Minimise any attractions or access to the trawl net itself

- All practicable stickers are removed from the net before each shot.
- Minimise the time the net is at or near the surface of the water. Shoot and haul as quickly as practicable.
- Regularly inspect and maintain gear and equipment to reduce the risk of gear failure.
- Where possible, conduct maintenance during periods of low risk to seabirds and with the net on board.

4. Minimise deck landings or vessel impacts by seabirds

- Keep additional and unnecessary deck lighting to a minimum so as not to attract or disorientate seabirds, especially while sheltering or at anchor.
- Keep gear and deck clean of any remaining fish waste where possible.
- Ensure crew are familiar with safe seabird handling procedures (see [DOC Handling and Release Guide](#)).

For More Information

Contact your Liaison Officer for any questions you may have. They will be working with you to try and achieve these Mitigation Standards. The full document is available on the [MPI website](#).

Managing artificial lights to reduce seabird vessel strikes



Aotearoa New Zealand is the seabird capital of the world. Our seabirds are taonga (treasures) and our long coastline is dotted with their colonies. Unfortunately, many of our seabirds are threatened with extinction, so managing threats, including light pollution, is critical to their survival.

Why is light management important?

Many seabirds get disorientated by artificial lights at night, which can lead to collisions with vessels (vessel strikes). Following vessel strikes, seabirds can be contaminated with chemicals on deck (eg oil or fuel), causing loss of waterproofing and subsequent drowning. Vessel strikes can also cause direct seabird deaths. The risk of vessel strike is highest during foggy and rainy nights.

What can you do to help seabirds?

We recommend taking the following actions, while maintaining vessel and crew safety.

- Minimise light use, especially spotlights and floodlights, when you are within 5 km of an offshore island, where most seabird colonies are located.
- Avoid unnecessary movements and activities at night.
- Eliminate unnecessary lights.
- Shield lights to only light areas essential for safe operations.
- Use lights with reduced or filtered blue and violet wavelengths (eg 2200 K).
- Use black-out blinds wherever possible.
- Practice safe seabird handling and release techniques when vessel strikes occur (see diagrams below).
- Record and report vessel strikes.

Commercial fishers

- Follow your Protected Species Risk Management Plan and operational procedures.
- Contact your liaison officer for more information.

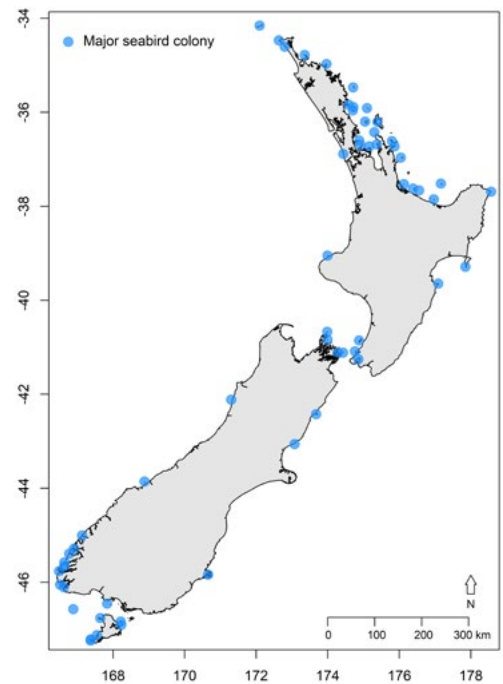

Shearwaters and petrels (including diving petrels, storm petrels and prions) are particularly susceptible to vessel strikes. *Photos: Oscar Thomas*

Safe seabird handling techniques

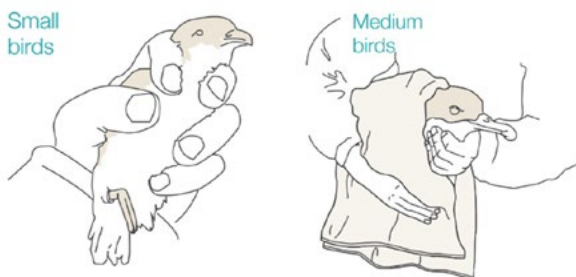

Safe release techniques

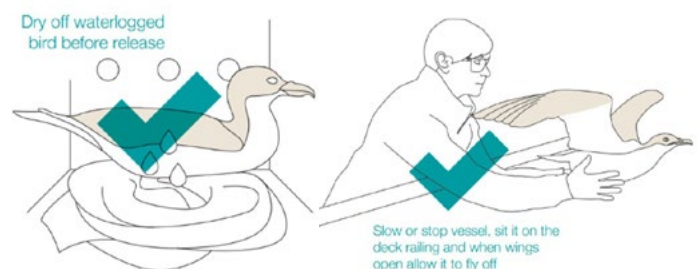

International and National Seabird Risk Frameworks

1. United Nations (UN) Law of the Sea, Fish Stocks Agreement & Responsible Fishing Agreement
 - Nations must catch their fish but not harm environment
2. UN -FAO delivers required base standards through IPOA for seabird risk management globally and each nation must have its own plan
3. Seabirds especially albatross are recognised as the world's most threatened bird group
4. Association for Conservation of Albatrosses and Petrels is a global treaty on reducing threats to seabirds and in New Zealand is the responsibility of the Department of Conservation (DOC) with Fisheries NZ involvement.
5. NZ has National Plan of Action (NPOA)-seabirds with 2 goals
 - No risk to populations (they can grow, not decline due to fishing)
 - As few deaths as practical (further affordable and sensible mitigation)
6. Fisheries Act allows for utilisation (catch your fish) while avoiding, remedying or mitigating adverse impacts on environment
7. Under the NPOA, NZ has a Seabird Risk assessment with each species given a '*risk-rating by fishery*' where there is a risk of unsustainable mortality levels
8. Crown/MPI (FNZ) obligated to meet the Act, therefore they have introduced mandatory measures in many fisheries, with more to come and undertake risk assessments
9. Crown (FNZ and DOC) being held to account by eNGOs and others
10. Most NZ trawl, line and net fisheries have issues with certain bird species
11. Anywhere bird captures are high and monitoring (observer coverage) is low will drive FNZ to meet its obligations with further interventions
12. FNZ has ability, and does, set limits on mortalities if seen necessary (e.g. NZ sea lions)
13. Industry associations have worked with and demonstrated to Government that a joint approach with risk plans, liaison and support is the best approach rather than more laws
14. Liaison/support programmes are in place for many sectors now (approximately 200 vessels inshore and deepwater) and more will be in as time goes on
15. These programmes are paid for by quota owners directly or through Govt. levies
16. Industry works hard to ensure the programmes are practical, sensible and that all vessels in a sector are dealt with the same way
17. Vessel owners as well as skippers need to understand these programmes and be engaged in them



Protected Species Information for Commercial Fishers

Toanui/Flesh-footed Shearwater

Where are flesh-footed shearwaters?

Breeding location: Toanui/Flesh-footed shearwaters breed on islands off the coast of north of New Zealand and in the Marlborough Sounds, Australia, and on St Pauls Island in the Indian Ocean. Mauima/Lady Alice Island, Northland Ohinai Island, Coromandel and Titi Island, Marlborough also carry large colonies.

Breeding time: Toanui/Flesh footed-shearwaters breed from September to May. When they are not breeding, they migrate to the Northern Hemisphere to forage around Japan, India, and North America.

Foraging distribution: Toanui/Flesh-footed shearwaters forage and feed in the entire inshore area of the North Island and the upper South island, with concentrations found closer to where they breed. Offshore they extend and are found on the East and West of the North Island. They are active at the day and night during their breeding season, with most feeding occurring during the day.



How to recognise flesh-footed shearwaters

Toanui/Flesh-footed shearwaters are approximately 45cm long and are dark brown. They have a light pink coloured bill and white-flesh coloured legs and feet.

Distribution Map:

The distribution map shows where flesh-footed shearwaters are more likely to be found during the breeding season and where bycatch has occurred.

The dark blue areas indicate where numbers are most concentrated (hot spots) for foraging and feeding. These areas are also where most captures have been reported.

This data was accumulated from 1997 to 2019 breeding seasons.

It is not illegal to capture seabirds. IT IS ILLEGAL not to report captures of seabirds.

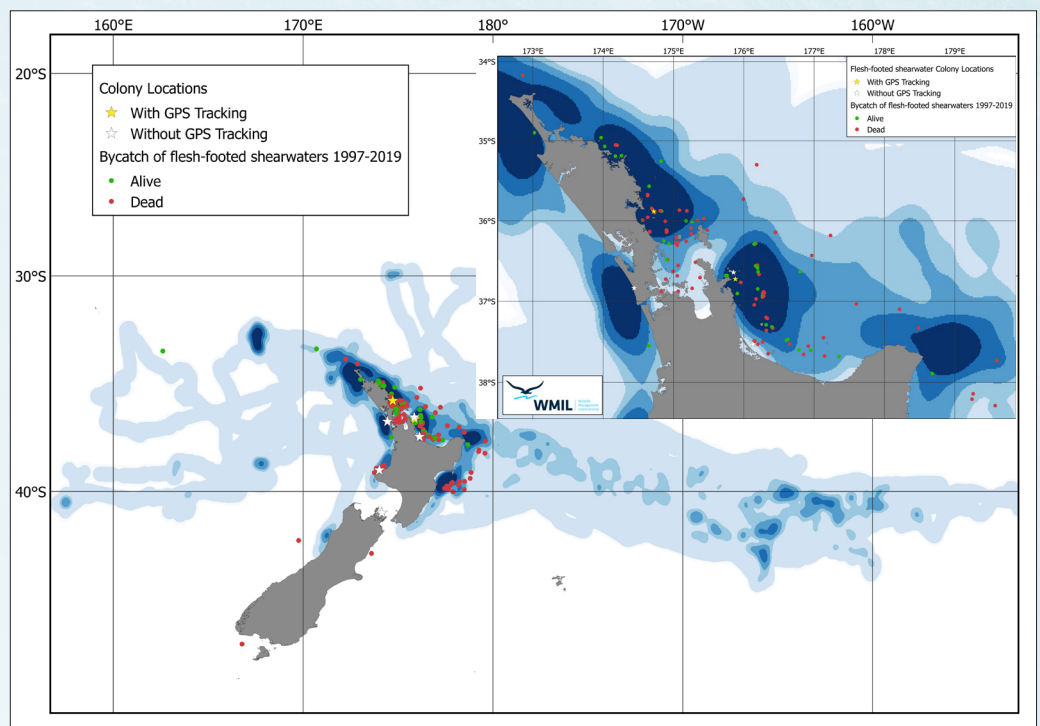



Protected Species Information for Commercial Fishers

Tākoketai/Black Petrel

Where are black petrels?

Breeding location: Tākoketai/Black petrel breed only in New Zealand. There are two remaining breeding colonies found in the Hauraki Gulf on Aotea/Great Barrier Island and Te-Hauturu-o-Toi/Little Barrier Island.

Breeding time: Tākoketai/Black petrel breed from October through to June each year. When they are not breeding, they migrate to South American waters to forage and feed.

Foraging distribution: Tākoketai/Black petrels forage and feed in the entire inshore area of the East Coast of the North Island from Mahia to Kaitaia. Their distribution is focused on deeper water near the continental shelf, with concentrations found closer to Great Barrier Island where they breed. Offshore they extend and are found on the East and West of the North Island.



How to recognise black petrels

Tākoketai/Black petrels are black or very dark brown, with black feet. The bill is pale yellow with a black tip and a distinctive double tube nostril on top.

Distribution Map:

The distribution map shows where Tākoketai/black petrels are more likely to be found during the breeding season and where bycatch has occurred.

The dark blue areas indicate where numbers are most concentrated (hot spots) for foraging and feeding. These areas are also where most captures have been reported.

This data was accumulated from 1997 to 2019 breeding seasons.

It is not illegal to capture seabirds. IT IS ILLEGAL not to report captures of seabirds.

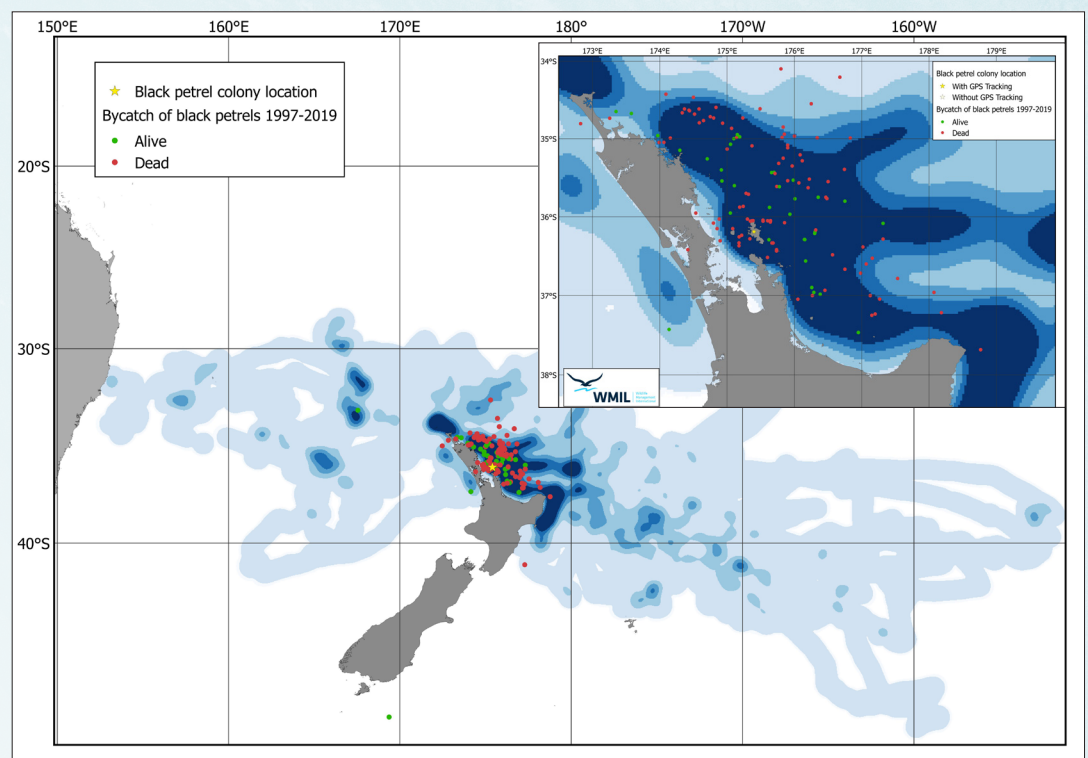

Under 28m trawl vessel: Observer PSRMP Audit



Trip Number	Observer Code	Vessel Name		Trip start date	Trip end date
Target Species		FMA's fished		Number of sets	
Name of Skipper(s)					

Record Yes (Y), No (N), Not Applicable (N/A) or Unknown (U) in the boxes provided. If you answer N or U to any questions, please make detailed comments on the reverse.

- Item 1 Did the vessel carry a copy of the appropriate Operational Procedures and 10 Golden Rules on board that was made available upon request?
- Item 2 Was a copy of the vessel's Protected Species Risk Management Plan (PSRMP) readily available and in a place accessible to all crew?
- Item 3 Were the skipper and crew familiar with the contents of the:
 - (a) Operational Procedures?
 - (b) 10 Golden Rules?
 - (c) Protected Species Risk Management Plan?
- Item 4 Were any protected species capture trigger points reached during the trip? (If yes, please describe in the comments)
- Item 5 After a trigger point was reached, did the crew: (If yes, please describe in the comments)
 - (a) Make changes to fishing operations?
 - (b) Change the mitigation measures they implemented?
- Item 6 Did a gear or equipment failure contribute to an increased risk of protected species captures during the trip? (If yes, please describe in the comments).
- Item 7 Were all protected species captures reported on the Non-Fish Protected Species Catch Return as required by fisheries reporting regulations?
- Item 8 Were protected species that were caught alive, handled and released according to the DOC Handling and Release Guide?

Fish waste management

- Item 9 Was all fish waste/offal discharge managed as per the vessel's PSRMP?
- Item 10 Was all fish waste held on board immediately before or during shooting or hauling?
- Item 11 Was fish waste batch discharged at intervals if discharged during the tow?

Warp strike mitigation

- Item 12 Was the warp maintenance adequate? (splices wrapped, sprags removed)
- Item 13 If present, was a warp strike mitigation device used in accordance with the Protected Species Risk Management Plan? (ie. time deployed and placement on vessel)
- Item 14 Were any other mitigation methods or deterrents used? (If yes, please describe in the comments)

Net interaction

- Item 15 Was the net kept at/near the surface for an unexpected or unnecessary amount of time? (If yes, please describe in the comments)
- Item 16 Was the net cleared of all practicable stickers prior to shooting?

Deck landing/impact

- Item 17 Were lighting practices managed in a way that avoids attracting or disorienting seabirds?

Please make a detailed comment for each item when required.

Item No:

Item No:

Item No:

Item No:

Item No:

Any further comments/observations: